

WATER BATHS WTB

according to DIN 12876-3; EN 61010-1 (IEC 61010-1); EN 61010-2-010

Standard units are safety-approved and bear the test marks:



- Interior: deep-drawn stainless steel tray (stainless steel W.St. 1-4301), heating mounted from the outside, without corners and edges for easy cleaning incl. central drain (no disturbing installations)
- Housing: textured stainless steel 1.4301 (ASTM 304), intuitive 3.5" colour graphic display with touch screen
- Connection: mains cable with plug (German type)
- Installation: 4 adjustable appliance feet

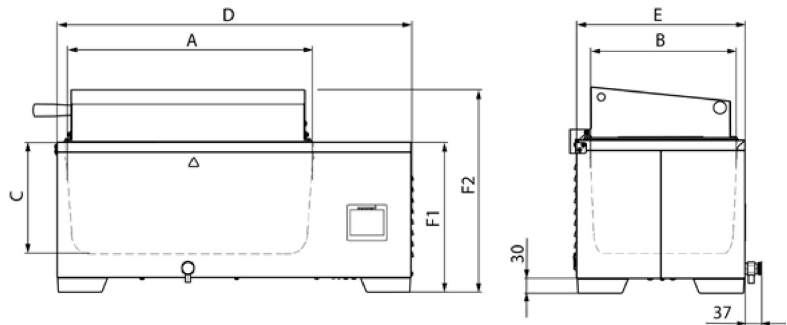

Model sizes/Description				6	11	15	24	35	50
Stainless steel interior	Volume	l		7.5	10	17.1	23.1	37.5	51
	Length	(A)	mm	277	267	482	472	602	592
	Width	(B)	mm	217	207	277	267	482	472
	Height	(C)	mm	150	200	150	200	150	200
Textured stainless steel exterior	Length	(D)	mm	479		749		868	
	Width	(E)	mm	289		349		554	
	Height (with flat cover)	(F1)	mm	272	322	272	322	272	322
	Height (with gable cover)	(F2)	mm	375	425	375	425	375	425
Standard equipment	Stainless steel gable cover			●					
Temperature	Working temperature range	°C	at least 5 above ambient temperature up to +100 (with cover, depending on ambient pressure)						
	Setting temperature range	°C	+10 to +100						
	Setting accuracy	°C	0,1						
Further data	Electrical load at 230 V, 50/60 Hz	W	1000		1420		2800		
	Electrical load at 115 V, 50/60 Hz	W	1000		1420		1800		
Packing data	Net weight	kg	11	12	18	20	30	33	
	Gross weight (packed in carton)	kg	13	14	21	23	34	37	
	Length	mm	579		849		968		
	Width	mm	389		449		654		
	Height	mm	475	525	475	525	475	525	
Order No. Water baths				WTB6	WTB11	WTB15	WTB24	WTB35	WTB50

Options	6	11	15	24	35	50
Voltage 115 V, 50/60 Hz	X2					
Accessories	6	11	15	24	35	50
Stainless steel gable cover	B50775		B50763		B50764	
Flat stainless steel cover with openings and concentric ring sets; 3 openings, Ø 87 mm	B48804			-		
Flat stainless steel cover with openings and concentric ring sets; 6 openings, Ø 107 mm	-		B48805		-	
Flat stainless steel cover with openings and concentric ring sets; 8 openings, Ø 107 mm		-			B48806	
Special flat stainless steel cover with openings and concentric ring sets; 3 openings, Ø 87 mm (only in combination with CPM650)	B48807			-		
Special flat stainless steel cover with openings and concentric ring sets; 6 openings, Ø 107 mm (only in combination with CPM650)	-		B48808		-	
Special flat stainless steel cover with openings and concentric ring sets; 8 openings, Ø 107 mm (only in combination with CPM650)		-			B48809	
Perforated bottom shelf, reversible for 2 heights (30 or 60mm), stainless steel	B50767		B50769		B50771	
Pump device for continuous circulation of the tempering medium, Voltage 230 V, 50/60 Hz, (requires installation and connection set B48813)			CPM650			
Installation and connection set for pump device CPM650 (incl. mounting bars for all different bath sizes)			B48813			
Shaking device for waterbaths incl. support frame, shaking frequency 35 - 150 strokes per minute (horizontal back/forth movement), requires special gable cover, Voltage 230 V, 50/60 Hz. Please do not forget to order the support basket.	-		SV1524		SV3550	
Shaking device for waterbaths incl. support frame, shaking frequency 35 - 150 strokes per minute (horizontal back/forth movement), requires special gable cover, Voltage 115 V, 60 Hz. Please do not forget to order the support basket.	-		SV1524X2		SV3550X2	
Support basket with perforated mounting shelf (stainless steel) with grid perforations to take clips for conical flasks (use of test tube racks not possible)	-		B48814		B48815	
Clip for 100 ml flask, max, flasks see sketch on demand	-			B02692		
Clip for 200 ml flask, max, flasks see sketch on demand	-			B02693		
Clip for 300 ml flask, max, flasks see sketch on demand	-			B02694		
Clip for 500 ml flask, max, flasks see sketch on demand	-			B02695		
Rack for shaking device for 171 test tubes Ø 14.5 mm	-		B48816		-	
Rack for shaking device for 119 test tubes Ø 18 mm	-		B48818		-	
Rack for shaking device for 45 test tubes Ø 32 mm	-		B48820		-	
Rack for shaking device for 475 test tubes Ø 14.5 mm		-			B48817	
Rack for shaking device for 357 test tubes Ø 18 mm		-			B48819	
Rack for shaking device for 117 test tubes Ø 32 mm		-			B48821	
Test tube racks, holes 2-row racks, 34 holes, Ø 10 mm each (bath capacity 3 racks)	B48822			-		
Test tube racks, holes 2-row racks, 30 holes, Ø 12 mm each (bath capacity 3 racks)	B48824			-		
Test tube racks, holes 2-row racks, 26 holes, Ø 14.5 mm each (bath capacity 2 racks)	B48826			-		
Test tube racks, holes 2-row racks, 22 holes, Ø 18 mm each (bath capacity 2 racks)	B48828			-		
Test tube racks, holes 2-row racks, 18 holes, Ø 21 mm each (bath capacity 2 racks)	B48830			-		
Test tube racks, holes 2-row racks, 14 holes, Ø 32 mm each (bath capacity 1 rack)	B48832			-		
Test tube racks, holes 3-row racks, 33 holes, Ø 18 mm each (bath capacity 1 rack)	B48834			-		
Test tube racks, holes 4-row racks, 44 holes, Ø 18 mm each (bath capacity 1 rack)	B48836			-		
Test tube racks, holes 2-row racks, 58 holes, Ø 10 mm each (bath capacity 4 racks)	-		B48823		-	
Test tube racks, holes 2-row racks, 58 holes, Ø 12 mm each (bath capacity 4 racks)	-		B48825		-	
Test tube racks, holes 2-row racks, 46 holes, Ø 14.5 mm each (bath capacity 3 racks)	-		B48827		-	
Test tube racks, holes 2-row racks, 38 holes, Ø 18 mm each (bath capacity 3 racks)	-		B48829		-	
Test tube racks, holes 2-row racks, 34 holes, Ø 21 mm each (bath capacity 3 racks)	-		B48831		-	
Test tube racks, holes 2-row racks, 22 holes, Ø 32 mm each (bath capacity 2 racks)	-		B48833		-	
Test tube racks, holes 3-row racks, 57 holes, Ø 18 mm each (bath capacity 2 racks)	-		B48835		-	
Test tube racks, holes 4-row racks, 76 holes, Ø 18 mm each (bath capacity 1 rack)	-		B48837		-	
Test tube racks, holes 2-row racks, 74 holes, Ø 10 mm each (bath capacity 9 racks)		-			B50656	
Test tube racks, holes 2-row racks, 66 holes, Ø 12 mm each (bath capacity 9 racks)		-			B50657	
Test tube racks, holes 2-row racks, 58 holes, Ø 14.5 mm each (bath capacity 8 racks)		-			B50658	
Test tube racks, holes 2-row racks, 50 holes, Ø 18 mm each (bath capacity 6 racks)		-			B50659	
Test tube racks, holes 2-row racks, 44 holes, Ø 21 mm each (bath capacity 6 racks)		-			B50660	
Test tube racks, holes 2-row racks, 30 holes, Ø 32 mm each (bath capacity 4 racks)		-			B50661	
Test tube racks, holes 3-row racks, 75 holes, Ø 18 mm each (bath capacity 4 racks)		-			B50662	
Test tube racks, holes 4-row racks, 100 holes, Ø 18 mm each (bath capacity 3 racks)		-			B50663	